

SLFE Pressed Steel Flange Units

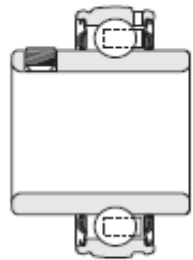

1000G

Standard

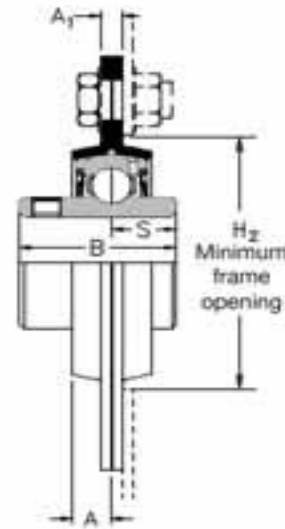
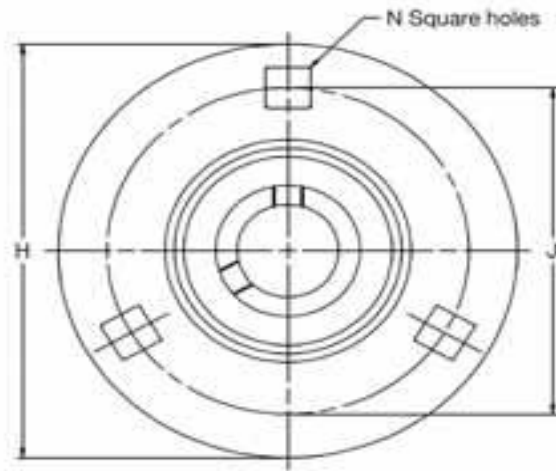
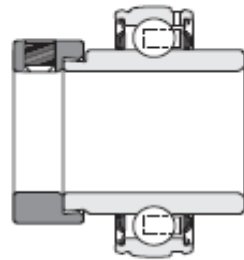

1000DECG

DEC Type

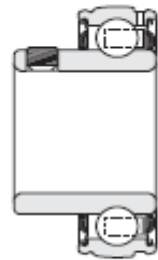

1200G

A Type

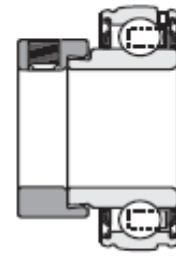

1200ECG

EC Type

See [Housed Bearing Insert](#) pages for dimensional detail

SLFE Pressed Steel Flange Units



Shaft Diameter (mm)		RHP designation	Variations	Basic Insert	Casting group	Dimensions(mm)									
Metric Range	Imperial Range		A	EC	DEC	H	H2	J	N	A	A1	B	S		
12		SLFE12	•			1017	1	81	49	63.5	7.1	6.7	4	27.38	11.58
	12.7	SLFE1/2	•			1017	1	81	49	63.5	7.1	6.7	4	27.38	11.58
15		SLFE15	•			1017	1	81	49	63.5	7.1	6.7	4	27.38	11.58
	15.875	SLFE5/8	•			1017	1	81	49	63.5	7.1	6.7	4	27.38	11.58
16		SLFE16	•			1017	1	81	49	63.5	7.1	6.7	4	27.38	11.58
17		SLFE17	•			1017	1	81	49	63.5	7.1	6.7	4	27.38	11.58
	19.05	SLFE3/4	•	•	•	1020	2	90.5	55	71.5	8.7	7.7	4	31	12.73
20		SLFE20	•	•	•	1020	2	90.5	55	71.5	8.7	7.7	4	31	12.73
	22.225	SLFE7/8		•	•	1025	3	95.2	60	76	8.7	8.7	4	34.1	14.33
	23.812	SLFE15/16		•	•	1025	3	95.2	60	76	8.7	8.7	4	34.1	14.33
25		SLFE25	•	•	•	1025	3	95.2	60	76	8.7	8.7	4	34.1	14.33
	25.4	SLFE1	•	•	•	1025	3	95.2	60	76	8.7	8.7	4	34.1	14.33
	28.575	SLFE1-1/8		•	•	1030	4	112.7	71	90.5	10.5	9	5	38.1	15.93
30		SLFE30	•	•	•	1030	4	112.7	71	90.5	10.5	9	5	38.1	15.93
	30.16	SLFE1-3/16		•	•	1030	4	112.7	71	90.5	10.5	9	5	38.1	15.93
	31.75	SLFE1-1/4	•	•	•	1030	4	112.7	71	90.5	10.5	9	5	38.1	15.93
	31.75	SLFE1-1/4L	•	•	•	1035	5	122.2	81	100	10.5	10	5	42.9	17.53
	34.925	SLFE1-3/8		•	•	1035	5	122.2	81	100	10.5	10	5	42.9	17.53
35		SLFE35	•	•	•	1035	5	122.2	81	100	10.5	10	5	42.9	17.53
	36.512	SLFE1-7/16		•	•	1035	5	122.2	81	100	10.5	10	5	42.9	17.53
	38.1	SLFE1-1/2	•	•	•	1040	6	147.8	91	119	13.5	10	7	49.2	19.03
40		SLFE40	•	•	•	1040	6	147.8	91	119	13.5	10	7	49.2	19.03
	41.275	SLFE1-5/8		•	•	1045	7	149.2	97	120.5	13.5	10	7	49.2	19.04
	42.862	SLFE1-11/16		•	•	1045	7	149.2	97	120.5	13.5	10	7	49.2	19.04
	44.45	SLFE1-3/4	•	•	•	1045	7	149.2	97	120.5	13.5	10	7	49.2	19.04
45		SLFE45	•	•	•	1045	7	149.2	97	120.5	13.5	10	7	49.2	19.04
	47.625	SLFE1-7/8		•	•	1050	8	155.6	102	127	13.5	10.5	8	51.6	19.04
	49.212	SLFE1-15/16		•	•	1050	8	155.6	102	127	13.5	10.5	8	51.6	19.04
50		SLFE50	•	•	•	1050	8	155.6	102	127	13.5	10.5	8	51.6	19.04
	50.8	SLFE2R				1050	8	155.6	102	127	13.5	10.5	8	51.6	19.04
	50.8	SLFE2			•	1055	9	166.6	113	138	13.5	10.7	8	55.6	22.24
	53.975	SLFE2-1/8			•	1055	9	166.6	113	138	13.5	10.7	8	55.6	22.24
55		SLFE55			•	1055	9	166.6	113	138	13.5	10.7	8	55.6	22.24

SLFE Pressed Steel Flange Units



Shaft Diameter (mm)		RHP designation	Variations	Basic Insert	Casting group	Dimensions(mm)							
Metric Range	Imperial Range		A EC DEC			H	H2	J	N	A	A1	B	S
55.562		SLFE2-3/16	•	1055	9	166.6	113	138	13.5	10.7	8	55.6	22.24
57.15		SLFE2-1/4	•	1060	10	176.2	122	147.6	13.5	11.9	8	65.1	25.44
60		SLFE60	•	1060	10	176.2	122	147.6	13.5	11.9	8	65.1	25.44
61.912		SLFE2-7/16	•	1060	10	176.2	122	147.6	13.5	11.9	8	65.1	25.44

Housings of groups 6 to 10 inclusive have four bolt holes

Note: these units are not re-greaseable